

HIGH FREQUENCY OFF GRID SOLAR INVERTER PV1800 LV Series

1~3KW | 120V | Wifi

PV1800 LV Series is a multi-function inverter/charger, combining functions of inverter, MPPT solar charger and battery charger to offer uninterrupted power support with portable size. Its comprehensive LCD display offers user-configurable and easy-accessible button operation such as battery charging current, AC/solar charger priority, and acceptable input voltage based on different applications.



- Pure sine wave solar inverter
- Output power factor 1
- Built-in 80A MPPT solar charger
- 2 units can be wired in parallel to create a split-phase system with 120V and 240V capabilities (only for 3kw)
- Support parallel operation up to 3 units (only for 3kw)
- WIFI remote monitoring (optional)
- CAN/RS485 communication for BMS
- Compatible to generator



Back panel description



Solar system connection

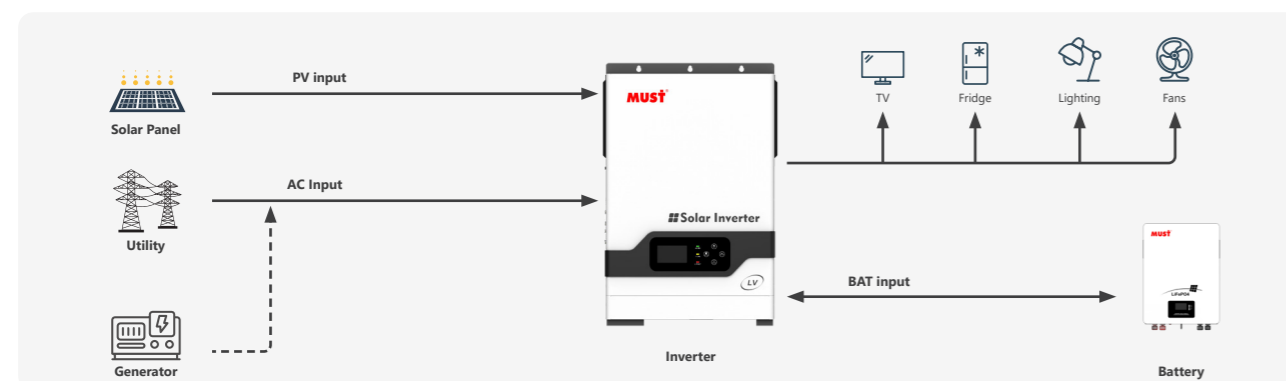

MODEL	PV18-1012 LV	PV18-1512 LV	PV18-1524 LV	PV18-2024 LV	PV18-3024 LV	PV18-3048 LV
Nominal Battery System Voltage	12VDC	12VDC	24VDC	24VDC	24VDC	48VDC
INVERTER OUTPUT						
Rated Power	1000W	1500W	1500W	2000W	3000W	3000W
Surge Power	1000W	1500W	1500W	4000W	6000W	6000W
Waveform	Pure sine wave					
AC Voltage Regulation (Batt.Mode)	120VAC ±5%					
Inverter Efficiency(Peak)	90%~93%					
Transfer Time	10ms (UPS / UL) 20ms (APL)					
AC INPUT						
Voltage	120VAC					
Selectable Voltage Range	107~132VAC(UL)					
Frequency Range	50Hz / 60Hz(Auto sensing)					
BATTERY						
Normal voltage	12VDC	12VDC	24VDC	24VDC	24VDC	48VDC
Floating Charge Voltage	13.7VDC	13.7VDC	27.4VDC	27.4VDC	27.4VDC	54.8VDC
Overcharge Protection	15VDC	15VDC	30VDC	30VDC	30VDC	60VDC
SOLAR CHARGER & AC CHARGER						
Max. PV Array Open Circuit Voltage	105V	145V	160V	160V	450VDC	250VDC
Max. Solar Charge Current	60A	60A	60A	60A	100A	80A
PV Array MPPT Voltage Range	15~105VDC	15~130VDC	30~128VDC	30~128VDC	90~430VDC	60~200VDC
PV Input Power	750W	750W	1500W	1500W	4000W	4000W
Maximum Efficiency	98%					
Maximum AC Charge Current	10A	10A	30A	40A	80A	60A
Maximum Charge Current	70A	70A	90A	100A	100A	140A
MECHANICAL SPECIFICATIONS						
Machine Dimension (W*H*D)(mm)	224*321*95	255*321*125	254.5*367.4*103		329*485*134	
Package Dimension (W*H*D)(mm)	410*188*300	416*216*342	436*189*331		575*425*229	
N.W(kg)	5.0	5.5	5.4	5.5	8	10
G.W(kg)	6.0	6.5	6.4	6.5	9.5	11.5
OTHER						
Humidity	5% to 95% Relative humidity (Non-condensing)					
Operating Temperature	-10°C~50°C					
Storage Temperature	-15°C~60°C					
Standard Warranty	2 years					
CERTIFICATION & STANDARDS						
CE-LVD (IEC62109-1, EN IEC62109-2); UKCA-(BS EN 62109-1, BS EN 62109-2)						

*The technical specifications of this document are subject to change without any notice