

ECO GREEN ENERGY
Building a Greener World

ATLAS by Eco Green Energy

390-410W

M10 / 182 mm Cell - 108 Half-cell

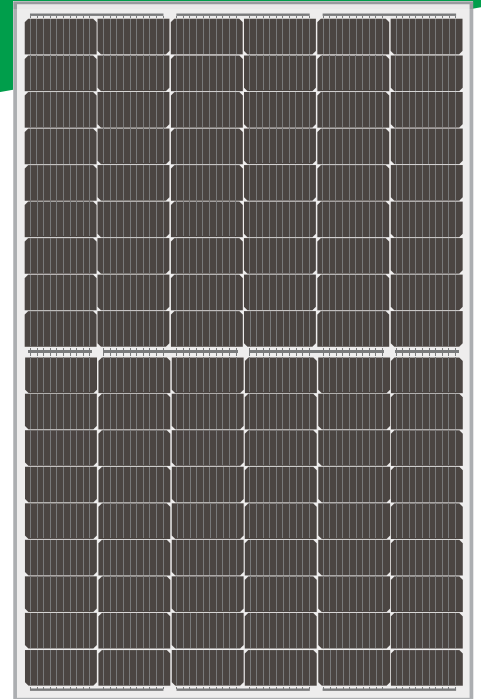

French Quality Module

Founded in 2008, Eco Green Energy is a french brand solar PV manufacturer and distributing now its PV module in more than 60 countries over the world. Atlas series solar modules are made only with grade A cells for highest power generation, lowest LCOE, and ensured more than 25 years lifespan.

KEY FEATURES



Gallium-doped Technology



Lower LCOE and BOS



Anti PID/ Low LID protection



Less Hot Spot Shading effects



Lower temperature coefficient

108-Cell

MONOCRYSTALLINE MODULE

20.97%

MAXIMUM EFFICIENCY

0~+5W

POSITIVE POWER TOLERANCE

GRADE A

CELLS GUARANTEED



LINEAR PERFORMANCE WARRANTY

12-Year Product Warranty · 25-Year Linear Power Warranty

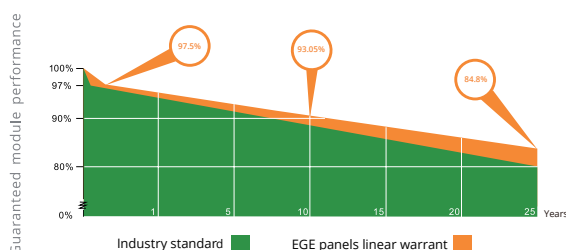

COMPREHENSIVE CERTIFICATES

IEC 61215/ IEC 61730 / IEC 61701 / IEC 6216
ISO 9001 : Quality Management Systems



ELECTRICAL DATA AT STC*

Power output (Pmax)	390 W	395 W	400 W	405 W	410 W
Power tolerance	0~+5 W	0~+5 W	0~+5 W	0~+5 W	0~+5 W
Module efficiency	19.95 %	20.20 %	20.46 %	20.72 %	20.97 %
Maximum power voltage (Vmp)	30.42 V	30.62 V	30.82 V	31.02 V	31.22 V
Maximum power current (Imp)	12.82 A	12.88 A	12.94 A	13.00 A	13.06 A
Open circuit voltage (Voc)	36.54 V	36.74 V	36.94 V	37.14 V	37.34 V
Short circuit current (Isc)	13.50 A	13.55 A	13.60 A	13.65 A	13.70 A

*Standard Test Conditions: Irradiance: 1 000 W / m² • Cell temperature: 25°C • AM: 1.5

ELECTRICAL DATA AT NMOT*

Power output (Pmax)	287 W	291 W	295 W	298 W	302 W
Maximum power voltage (Vmp)	28.38 V	28.58 V	28.78 V	28.98 V	29.18 V
Maximum power current (Imp)	10.11 A	10.18 A	10.25 A	10.28 A	10.35 A
Open circuit voltage (Voc)	34.09 V	34.29 V	34.49 V	34.69 V	34.89 V
Short circuit current (Isc)	10.60 A	10.65 A	10.70 A	10.75 A	10.80 A

*Nominal Operating Cell Temperature: Irradiance: 800 W / m² • Ambient temperature: 20°C
• AM: 1.5 • Wind speed: 1 m/s

MECHANICAL CHARACTERISTICS

Cell type	Monocrystalline (182x91 mm)
Number of cells	108
Dimensions	1724x1134x35mm (1.5mm Cell Gap)
Weight	22 kg
Glass	3.2 mm tempered glass, High transmission (>94%), Anti-Reflective Coating
Frame	Anodized aluminium alloy
Junction box	IP68 rated (3 by pass diodes)
Cable	4.0mm ² ; 300mm(+) / 400mm(-) ; Length can be customized
Connector	MC4 or MC4 compatible
Max front load (e.g.: snow)	5400 Pa
Max back load (e.g.: wind)	2400 Pa

TEMPERATURE CHARACTERISTICS

NOCT	45°C ±2 °C
Temperature coefficient of Pmax	-0.35%/°C
Temperature coefficient of Voc	-0.28%/°C
Temperature coefficient of Isc	+0.048%/°C

MAXIMUM RATINGS

Operating temperature range	-40 °C ~+85 °C
Maximum system voltage	1500 DC (IEC) 1500 DC (UL)
Max series fuse rating	25 A

PACKAGING (1724x1134x35mm)

Type	Pcs	Weight
Per Pallet	31 pcs	715 kg
40ft HQ Container	806 pcs	18.6 t

Dimension of PV Module (mm)

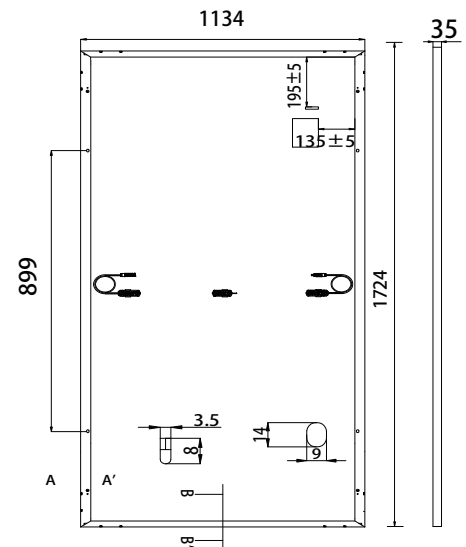

Frame Cross Section A-A

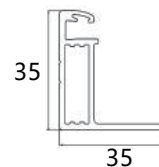

Frame Cross Section B-B

